

ROTATOR FHR 16FD1-A8

- 

STATIC LOAD
160 kN
- 

DYNAMIC LOAD
80 kN
- 

TORQUE at 25MPa
3400 Nm
- 

OILFLOW
40 l/min
- 

WEIGHT
75 kg



DOUBLE BEARING

Grapple open
G1/2" Max 300 bar

Rotate left/right
G1/2" Max 250 bar

Rotator frame
L103.2 D50.8

Grapple close
G1/2" Max 300 bar

Rotator designed for intensive professional use and extended long lifetime

Rotator with two bearings to withstand compression and stretching forces

Grapple open
G1/2"

Robust and shock resistant steel flange for fitting the grapple in standard pattern

Grapple close
G1/2"

Optional open/close channels

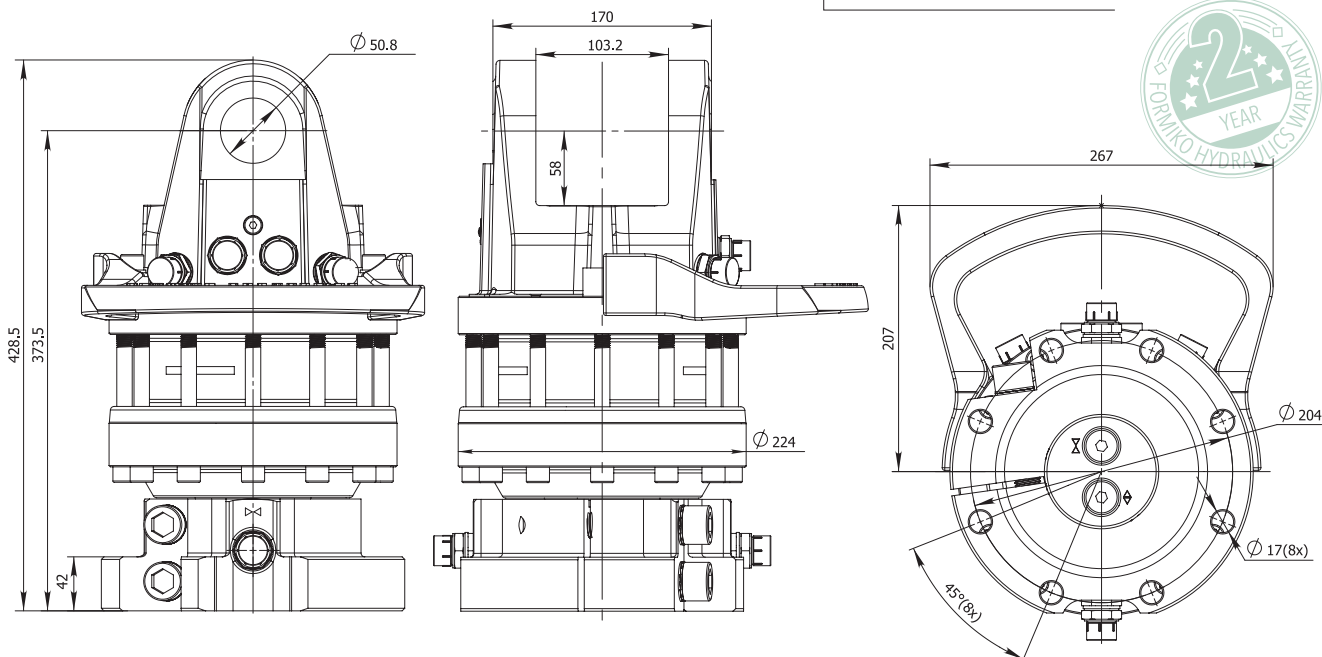

- FORESTRY 
- AGRICULTURE 
- CONSTRUCTION 
- GENERAL CARGO 
- RECYCLING 