

**seppi m<sup>®</sup>**

MULCHING EQUIPMENT SPECIALISTS

Flail Mulchers  
SMW · SMO

# Flail Mulchers

## 20-120 HP



# S5 cabrio

30-90 HP    Ø max. 5/12 cm [2/5 inches]

## Lightweight powerhouse - reliable for use as a high-grass mulcher

With a double skin casing made of wear resistant steel, the S5 cabrio is a perfect mulcher for exacting conditions. The lightweight construction allows work on sloping ground. With a manual inverter the mulching result can be optimized.

Depending on the direction of the rotor shaft it mulches low or high grass and brush.

### Standard version and characteristics

- > Mulches grass and brush up to 5 cm [2"]Ø

---

- > Working speed 3-10 km/h

---

- > 3 point linkage cat. 1&2 front attachment or push

---

- > 540 rpm gearbox without freewheel with manual inverter

---

- > STOPSAFE™ System

---

- > Belt transmission

---

- > Hydraulic adjustable front hood with chain protection

---

- > Rear protection with rubber flap

---

- > Support roller 152 mm Ø

---

- > Standard rotor with Y flails

---

### Optional configuration and accessories

- > Forestry rotor mulches brush and wood up to 12 cm [5 inch] with swinging or fixed hammers

---

- > 1000 rpm gearbox

---

- > Roller scraper

---



[www.youtube.com/seppimulcher](https://www.youtube.com/seppimulcher)

Specifications • S5 cabrio						
Working width	cm [inch]	<b>125 [49]</b>	<b>155 [61]</b>	<b>175 [69]</b>	<b>200 [79]</b>	<b>225 [88]</b>
Overall width	cm [inch]	137 [54]	167 [66]	187 [74]	212 [84]	237 [93]
Depth	cm [inch]	90 [35]	90 [35]	90 [35]	90 [35]	90 [35]
Height	cm [inch]	105 [41]	105 [41]	105 [41]	105 [41]	105 [41]
Weight (base value)	kg [lb]	380 [840]	425 [940]	480 [1,060]	540 [1,190]	610 [1,350]
Belts	qty	4	4	4	4	4
Y flails	qty	24	27	33	39	45
Swinging hammers	qty	21	26	29	-	-
Fixed hammers	qty	27	33	-	-	-
Nominal tractor power	HP	30-90	30-90	40-90	50-90	50-90

### Tools

- Flails  
**Y DUO**

---

- Swinging hammers  
**FORST**

---

- Fixed hammers  
**MINI-DUO**

S5 cabrio · features

Robust reinforced double wall chassis made of high tensile and wear resistant steel AR400.

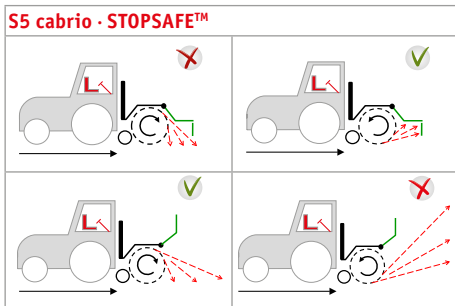

The STOPSAFE™ system for S5 cabrio avoids improper use of the machine. The system switches off the rotation if the rotor runs upwards and the hood is being opened. At the same time, if the hood is open it prevents the selection of the upward rotor direction.

**Wide-open hydraulic front hood to mulch high grass**

**Linkage frame suitable for most current implement carriers and for tractors with reverse drive**

**Tempered counter cutters for a perfect mulching result**

**Optional forestry rotor with swinging hammers**

**Optional forestry rotor with fixed hammers**

**Standard rotor with Y flails**

**Adjustable roller, Reinforced bearing and roller- Large diameter roller allows mulching on uneven ground**