

seppi m[®]

MULCHING EQUIPMENT SPECIALISTS

Flail Mulchers
SMW · SMO

Flail Mulchers

20-120 HP



SML

20-50 HP Ø max. 3 cm [1.2 inch]

Lightweight mulcher for light tractors

The SML flail mower is ideal for low nominal power tractors. Several options are available for the machine, guaranteeing a perfect result, whatever the conditions.



Standard version and characteristics

- > Mulches grass and brush up to 3 cm [1.2"]Ø

- > Working speed 3-10 km/h

- > 3 point rear linkage cat. 1&2 central fixed

- > 540 rpm gearbox with freewheel

- > Belt transmission

- > Front protection: metal flaps

- > Rear protection: rubber flap

- > Support roller 133 mm [52"] Ø

- > Standard rotor with SMW flails optionally with Y flails



Height-adjustable support roller

Metal flaps in the front and rubber protection in the back protect tractor and driver

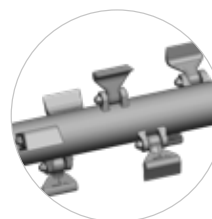

Standard rotor with SMW flails

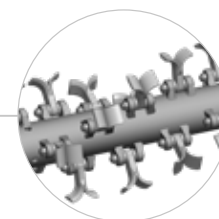

Optional rotor with Y flails

Specifications · SML

Working width	cm [inch]	105 [41]	125 [49]	155 [61]	175 [69]	200 [79]
Overall width	cm [inch]	125 [49]	145 [57]	175 [69]	195 [77]	220 [87]
Depth	cm [inch]	90 [35]	90 [35]	90 [35]	90 [35]	90 [35]
Height	cm [inch]	95 [37]	95 [37]	95 [37]	95 [37]	95 [37]
Weight (base value)	kg [lb]	265 [580]	290 [640]	330 [720]	350 [770]	380 [840]
Belts	qty	3	3	3	3	3
Flails	qty	9	12	15	18	21
Y flails	qty	18	24	27	33	39
Nominal tractor power	HP	20-50	20-50	20-50	20-50	20-50

Tools

